

CERTIFIED RECORD OF LAND CORNER MONUMENTATION

J-24.25

History of original corner establishment:

NONE

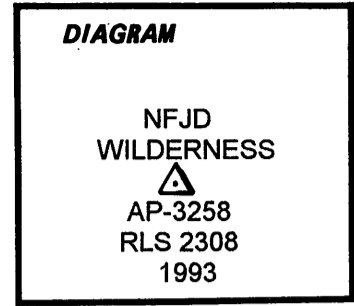

Description of corner evidence found:

NONE

Description of monument and accessories I established to perpetuate the original location of this corner:

At the intersection of the section line of sections 12 and 13, T. 8 S., R. 33 E., with an unnamed creek, I set a 5/8" by 36" rebar, with a 3 1/4" aluminum cap, 32" in the ground, from which:

- 6" Englemann Spruce bears, S. 44° E., 15.0 feet, marked "WB/3258" "BT".
- 22" Englemann Spruce bears, N. 15 1/2° W., 26.3 feet, marked "WB/3258" "BT".

The BT's are double blazed and have a brass washer stamped "RLS 2308" nailed to the lower blaze by the "BT" scribing.

Magnetic Declination: 20° East

Work Performed By: David A. Schlaich (RLS 2308)
Witnessed By: Troy Allen, Ira McCauley & Shane Sills

Date: September, 1993

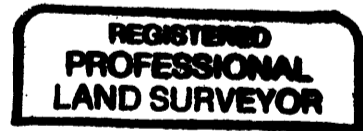

David A. Schlaich

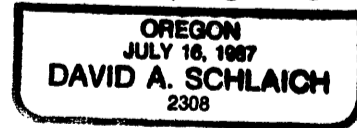

Expires 12/31/94

Office of... Surveyor County of... Grant

State of... Oregon, I hereby certify that the within instrument was filed in this office for record on the... 2 day of... Feb, 19... 94

Robert D. Baggett by
(COUNTY OFFICIAL) (DEPUTY)